

New LoWatt

Kitchen & Utility Room fans



Long Life Ventilation

Vent-Axia LoWatt fans feature LoWatt long life DC energy saving motors that last 5 times longer than conventional motors, whilst delivering up to 80% energy savings. The extended life of LoWatt fans is due to the use of a new generation of high quality electronically controlled ball-bearing motors especially developed for this range. The motors are perfectly designed for the wet conditions of utility rooms and kitchens, extracting stale, moisture-laden air quietly and efficiently.

Shutters

Vent-Axia LoWatt fans have instant shutters using patented Integral Magnetron Control (IMC) technology ensuring that the fan is only open to the outside world when it is working - with no extra power used to operate the shutter. This means that the only air to escape is the air extracted. When the fan stops the shutter closes firmly, until the fan operates again.

Installation

The range is suitable for installation in panels, walls or windows using the kits available. LoWatt fans are quick and simple to fit using reversible grommets and easy-wire terminals, and are suitable for wall or ceiling mounting at any angle.

150mm telescopic wall kits are available with a white or brown outside grille. The kit is supplied with a telescopic wall sleeve to fit walls 225-360mm thick.

Window fitting kits are available for use with all LoWatt 150mm models through single or double glazed windows up to 40mm thick.

The range meets the requirements of the current Building Regulations Document F for the ventilation of utility rooms 30l/s and for kitchens 60l/s.

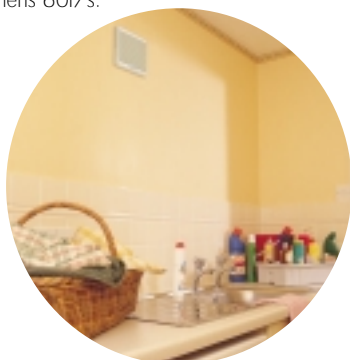

FAQ's Answered

LoWatt fans are suitable for installation in windows, walls, panels or ceilings.

LoWatt fans can be installed at any angle.

On board power supply for easy installation.

Fitted with instant automatic shutter.

A mains PIR sensor is available



Features and Benefits

- > Long life LoWatt motor lasts 5 times longer than conventional motors.
- > Up to 80% energy saving.
- > Meets current building regulations when installed.
- > Unique patented instant electric opening shutter with positive closure.
- > IP44 rated.
- > Low sound levels.
- > keymark certified.
- > 5 Year Guarantee.

Kitchen and Utility models

LoWatt U/KP (Shutter/Pullcord) - Ultra long life DC energy saving motor. Patented instant electric opening shutter. Controlled with integral power supply with pullcord On/Off switch.
Stock Ref No. 45 91 23

LoWatt U/KT (Shutter/Timer) - Ultra long life DC energy saving motor. Patented instant electric opening shutter. Controlled with integral power supply with electronic adjustable overrun timer (5-25 minutes).
Stock Ref. No. 45 91 24

LoWatt U/KH (Shutter/Humidistat) - Ultra long life DC energy saving motor. Patented instant electric opening shutter. Controlled with integral power supply with pullcord override switch and adjustable humidity sensor (60-95% RH).
Stock Ref No. 45 91 25

Wall Kits

150mm Wall Kit White - 14 09 02A
150mm Wall Kit Brown - 14 09 03A

Window Kit

150mm Window Kit White - 14 09 01A

Typical Specification

LoWatt U/KP, U/KT, U/KH
Supply and install a LoWatt fan with integral magnetron shutter (IMC) and removable grille as manufactured by Vent-Axia Ltd, Fleming Way, Crawley, West Sussex RH10 9YX. Telephone: 01293 526062. The fan case and grille shall be made from ABS plastic and have an axial impeller.

The fan should be double insulated to meet IEE regulations and meet the Building Regulation (Document F) requirements of 30 litres a second for utilities and 60 litres a second for kitchens.

The electronically controlled motor is fitted with long life ball bearings to provide an expected 50,000 hour running life and a Standard Thermal Overload Protection (S.T.O.P.). The motor should be insulated to Class III (-25°C to +40°C) and is to conform to BS EN 60335-2-80.

Operation via pullcord, external switch with overrun timer or humidity control/pullcord.

The fan is to be wall mounted using a wall kit 14 09 02A (white) or 14 09 03A (Brown), or window mounted using a window kit 14 09 01A (white).



Intelligent Controls

For even more energy efficiency the Vent-Axia LoWatt range is available with Integral Timer or integral Humidity Sensor. Remote PIR sensors are available which operate the fan only when required.

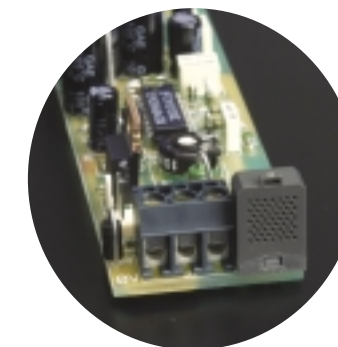

Easy wire terminals, for simple installation, offers the choice of either kitchen or utility room performance.

NOTE: The Transformer is an integral part of the fan which MUST NOT be installed as a SELV product.

Dimensions (mm)

	A	B	C	DØ	E	F	G	HØ
Kitchen/Utility	216	224	80	146	60	55	104	152
Weight	1.2kg							

LoWatt Kitchen/Utility

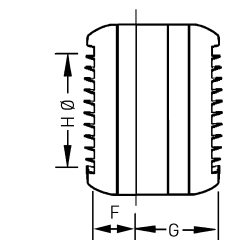
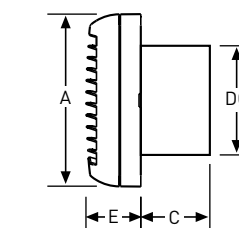
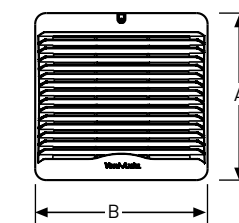

Panel fixing hole Ø 152mm
Wall fixing hole Ø 152mm
Window fixing hole Ø 152mm

For Wiring Diagrams see pages 220.

Performance

Output is for the extract airflow, dependant on setting.

Model	Stock Ref	Description	Watts	m³/h	l/s	dB(A) @ 3m
UTILITY SETTING						
LoWatt U/KP	45 91 23	axial/pullcord	7.5	160	46	33
LoWatt U/KT	45 91 24	axial/timer	7.5	160	46	33
LoWatt U/KH	45 91 25	axial/humidistat	7.5	160	46	33
KITCHEN SETTING						
LoWatt U/KP	45 91 23	axial/pullcord	11.5	230	64	36
LoWatt U/KT	45 91 24	axial/timer	11.5	230	64	36
LoWatt U/KH	45 91 25	axial/humidistat	11.5	230	64	36

WALL KIT 14 09 02A (White) 14 09 03A (Brown)
WINDOW KIT 14 09 01A (White)

