

# CA-Roof

**NEW**

**LONG LIFE**

**30.000 h**

**BALL BEARING**

- 6 models, with deliveries up to 1,600 m<sup>3</sup>/h.
- Painted, galvanised steel with ABS hood.
- Asynchronous, external rotor motor with turbine fan.
- IPX4 splash protection.
- Operating temperatures from -20° to +55°.



Roof-mounted installation



Installation with protection grille



Installation with backdraught shutter

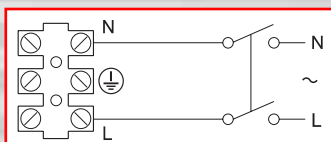

Product	Code	V	Hz	W	A	Rpm	Delivery m <sup>3</sup> /h	l/s	mm H <sub>2</sub> O	Max P Pa	Lp dB(A) 3m	Approval	kg	Insulation	IP prot.	max °C
CA 125 RF	I6013	220-240	50	75	0,34	2300	350	97	32	314	54	CE	4,6	cl. I	X4	55
CA 150 RF	I6023	220-240	50	80	0,34	2370	450	125	27	265	56,5	CE	7	cl. I	X4	55
CA 160 RF	I6073	220-240	50	150	0,68	2650	750	208	60	588	64	CE	8,8	cl. I	X4	55
CA 200 RF	I6043	220-240	50	160	0,69	2700	850	236	55	539	63	CE	8	cl. I	X4	55
CA 250 RF	I6053	220-240	50	180	0,80	2430	1180	327,5	58	568	61,5	CE	9,9	cl. I	X4	55
CA 315 RF	I6063	220-240	50	250	1,1	2480	1600	444,5	75	735	64,5	CE	11	cl. I	X4	50

## PRESSURE/AIRFLOW CURVES

CA 125 RF (I6013)

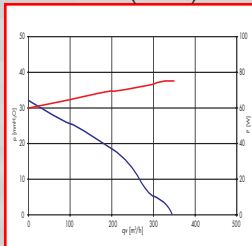

CA 150 RF (I6023)

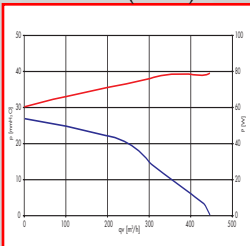

CA 160 RF (I6073)

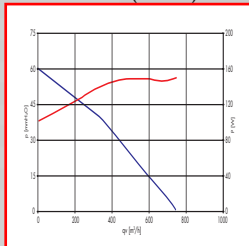

CA 200 RF (I6043)

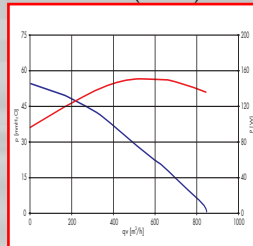

CA 250 RF (I6053)

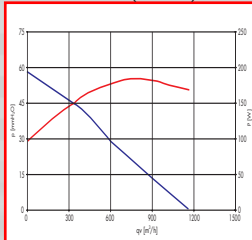

CA 315 RF (I6063)

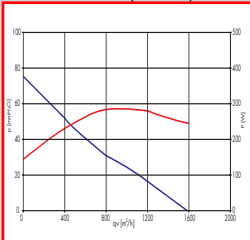

ps p

## DIMENSIONS

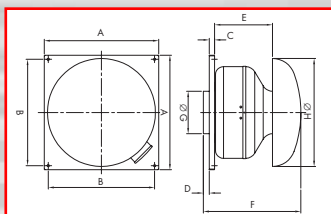

Models	A	B	C	D	E	F	Ø G	Ø H
CA 125 RF	334	280	20	2	193	290	122	300
CA 150 RF	424	370	20	17	198	340	147	400
CA 160 RF	424	370	20	22	214	361	157	400
CA 200 RF	424	370	20	17	203	345	197	400
CA 250 RF	489	435	20	27	193	376	247	534
CA 315 RF	489	435	20	21	226	403	312	534

## ACCESSORIES INCLUDED

### GALVANISED SHEET-METAL BRACKETS

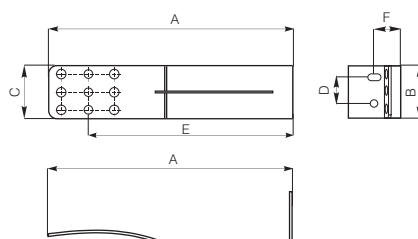
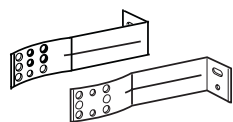

CA / CA-V0	A	B	C	D	E	F
100-125-150	186	40	40	20	156	10

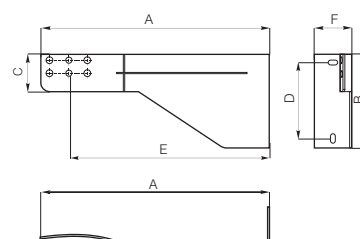

CA / CA-V0	A	B	C	D	E	F
160-200-250-315	245	100	40	80	215	10

## ACCESSORIES OPTIONAL

### SCNRB - C 1,5 - C 2,5

Non reversible variable electronic speed controller.

#### SCNR - C 1,5 - C 2,5

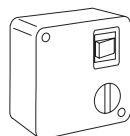

	Code	Products
SCNRB (flush fitting electr. speed controller)	12971*	for all products
SCB Kit (to convert SCNR to flush)	22481	for SCNR
C 1,5	12966	for all products up to 1,5 A Max
C 2,5	12967	for all products up to 2,5 A Max

#### SCNRB

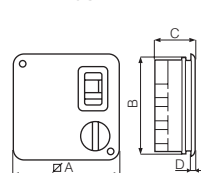

#### C 1,5 - C 2,5

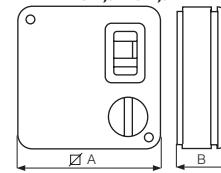

	V	W	kg	Insulation
SCNRB (flush fitting electr. speed controller)	220-240	200	0,2	cl. II
C 1,5	220-240	1,5 A	0,2	cl. II
C 2,5	220-240	2,5 A	0,2	cl. II

Dimensions (mm)	∅A	B	C	D
SCNRB	142	135	59,5	4,5
C 1,5	120	43	-	-
C 2,5	120	43	-	-

### CA - MU

Special galvanized sheet-metal brackets.

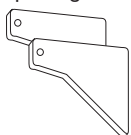

	Code	Products
CA-MU	22674	for all products

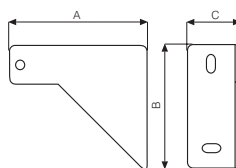

Dimensions (mm)	A	B	C
CA-MU	84	75	35

### SUB FRAME

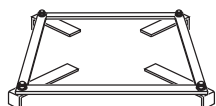

	Code	Products
CARF C 125	22543	16013
CARF C 150-160-200	22544	16023/16073/16043
CARF C 250-315	22545	16053/16063

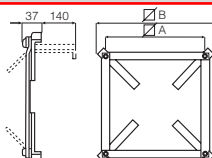

Dimensions (mm)	Code	∅A	∅B
TR-CU 10/15	22511	357	401
TR-CU 20/30/50	22512	500	541
TR-CU 70/100-4P	22539	750	791
TR-CU 100/150-6P/8P	22540	900	941

### PIPE CLAMPS

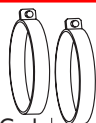

	Code	Products
CA-FU 100	22667	16000/16001/16008/16002/16013
CA-FU 125	22668	16010/16011/16018/16012/16023
CA-FU 150	22669	16020/16028/16022/16073/16023
CA-FU 160	22666	16020/16028/16022/16072/16073
CA-FU 200	22671	16070/16071/16030/16040/16035/16045/16042/16043
CA-FU 250	22672	16050/16051/16055/13052/16053
CA-FU 315	22673	16060/16061/16065/16062/16063

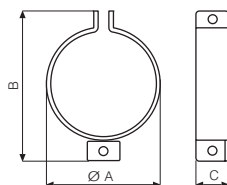

Dimensions (mm)	∅A	B	C
CA-FU 100	103	138	30
CA-FU 125	128	163	30
CA-FU 150	153	188	30
CA-FU 160	163	189	30
CA-FU 200	203	198	30
CA-FU 250	253	238	30
CA-FU 315	318	288	30

### GALVANISED SHEET-METAL BACKDRAUGHT SHUTTER



With aluminium shutters and return spring, for preventing back-draughts or penetration of rain when the unit is turned off.

	Code	Products
IN-LINE S 100	22551	17001/17005/17021/17025
IN-LINE S 125	22556	17002/17022
IN-LINE S 150	22562	17003/17023
IN-LINE S 160	22563	17004/17024
IN-LINE S 200	22566	17006/17026
IN-LINE S 250	22571	17009
IN-LINE S 315	22576	17010

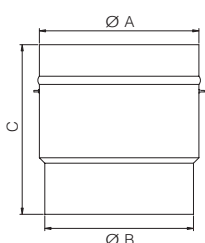

Dimensions (mm)	∅A	B	C
IN-LINE S 100	103	96	100
IN-LINE S 125	128	122	110
IN-LINE S 150	153	146	120
IN-LINE S 160	163	156	125
IN-LINE S 200	203	196	150
IN-LINE S 250	253	247	180
IN-LINE S 315	318	312	210

# ACCESSORIES OPTIONAL

## INTAKE PORT PROTECTION GRILLE



For use on intake port, to prevent accidents when the fan is installed within reach (EN Standard EN 294).

	Code	Products
CA-G 100	22750	16000/16001/16002
CA-G 125	22755	16010/16011/16012/16013
CA-G 150	22760	16020/16022/16023
CA-G 160	22762	16070/16071/16072/16073
CA-G 200	22765	16030/16040/16042/16043
CA-G 250	22770	16050/16051/16052/16053
CA-G 315	22775	16060/16061/16062/16063

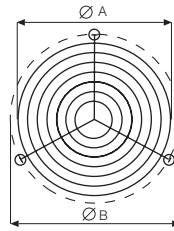

Dimensions (mm)	Ø A	Ø B	C
CA-G 100	82	99	3x120°
CA-G 125	102	124	3x120°
CA-G 150	142	149	3x120°
CA-G 160	142	159	3x120°
CA-G 200	142	183	3x120°
CA-G 250	182	220	3x120°
CA-G 315	222	260	3x120°

## FIXED GRILLE

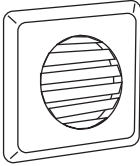

For use on outside walls, to prevent accidents when the fan is installed within reach (EN Standard EN 294).

	Code	Products
GFI 10	22010	16000/16001/16008
GFI 12/15	22020	16010/16011/16020/16018/16028/16070/16071

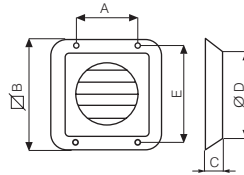

Dimensions (mm)	A	∅ B	C	∅ D	E
GFI 10	100	150	24	97	133
GFI 12/15	110	197	134	157	180

## OUTLET PORT PROTECTION GRILLE



To prevent accidents when the fan is installed within reach (EN Standard EN 294).

	Code	Products
TRA 250	51150	16030/16040/16050/16051/16035/16045/16055/16002/16012
TRA 350	51350	16060/16061/16065/16022
TRA 400	51450	16072/16042/16052
TRA 500	51550	16062

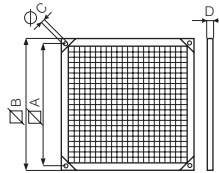

Dimensions (mm)	∅ A	∅ B	∅ C	D
TRA 250	280	305	8	10
TRA 350	380	405	8	10
TRA 400	430	455	8	10
TRA 500	530	555	8	10

## GRAVITY SHUTTER



	Code	Products
PGR 250	50150	16002/16012
PGR 350	50350	16022
PGR 400	50450	16072/16042/16052
PGR 450/500	50550	16062

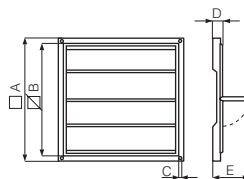

Dimensions (mm)	∅ A	∅ B	C	D	E
PGR 250	296	280	6	20	68
PGR 350	396	380	6	20	68
PGR 400	446	430	6	20	117
PGR 450/500	546	530	6	30	127

## ENVIRONMENTAL SENSORS

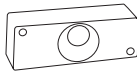

	Code	Products
C HCS-HUMIDITY	12994	All Lineo models (variants without timer)
C TEMP-TEMPERATURE	12992	All Lineo models (variants without timer)
C SMOKE	12993	All Lineo models (variants without timer)
C PIR-MOVEMENT DETECTOR	12998	All Lineo models (variants without timer)
C TIMER	12999	All Lineo models (variants without timer)

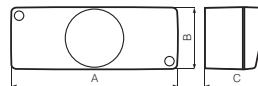

	A	B	C
ENVIRONMENTAL SENSORS	144	54	55,8

Code 5.170.084.898

Vortice Elettrosociali S.p.A.  
Strada Cerca, 2  
Frazione di Zoate  
20067 Tribiano (Milano)  
Tel. (+39) 02 906991  
Fax (+39) 02 90699314  
Italia  
export@vortice-italy.com

Vortice France  
72, Rue Baratte-Cholet  
94106 Saint Maur  
CEDEX  
Tél. (+33) 1.55.12.50.00  
Fax (+33) 1.55.12.50.01  
France  
contact@vortice-france.com

Vortice Limited  
Beeches House-Eastern Avenue  
Burton on Trent  
DE13 0BB  
Tel. (+44) 1283-49.29.49  
Fax (+44) 1283-54.41.21  
United Kingdom  
getit@vortice.ltd.uk



www.vortice.com  
www.vortice-france.com  
www.vortice.ltd.uk