

## MPC LONG CASED AXIAL RANGE RED HUB

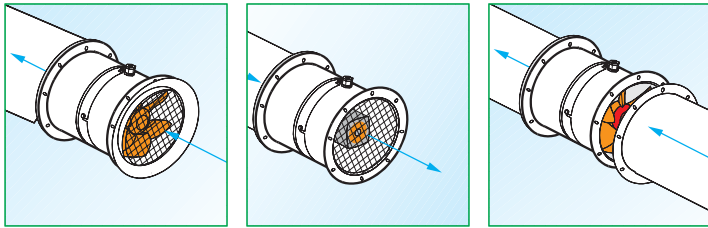

- Suitable for business or industrial buildings and general ducted ventilation in storerooms, large areas, farm buildings, hot houses, underground parking facilities, etc.
- Asynchronous induction motor with IP55 protection and ball-bearing-mounted rotor.
- Wiring-profiled fan, superimposed to reduce air-turbulence noise.
- Two-part, flanged frame, assembled with four screws to

allow attachment to standard ducting and steel motor support. Protected by black epoxy-polyester paint, the frame is easily removed for cleaning and maintenance. Specially designed for silent operation.

- Speed can be adjusted by means of an optional speed controller.
- Ambient temperature limits: -25° min. +70°C max.

Wiring diagrams shown on page XXXVII.



*These units are only suitable for extracting dust-free, acid-free and non-corrosive air. Suitable for extraction through ducting and filters. Ideally suited for installation into duct runs.*

M: Monophase (Single phase) 220-240 V - 50 Hz  
 T: Triphase (Three phase) 380 - 415 V - 50Hz

| Product   | Code  | V ~ 50 Hz          | W          | A                      | Poles | Rpm  | Delivery |        | P max  |     | Lp dB(A) (3 m) | kg   | Insulation | IP | max °C |
|-----------|-------|--------------------|------------|------------------------|-------|------|----------|--------|--------|-----|----------------|------|------------|----|--------|
|           |       |                    |            |                        |       |      | m³/h     | l/s    | mm H₂O | Pa  |                |      |            |    |        |
| MPC 252 M | 42253 | 220-240            | 330-335    | 1.65-1.65              | 2     | 2800 | 1820     | 505.6  | 38.5   | 378 | 65.5           | 8.3  | ⏚ cl. I    | 55 | 70     |
| MPC 254 M | 42255 | 220-240            | 100-110    | 0.60-0.61              | 4     | 1400 | 1100     | 305.6  | 10.0   | 98  | 48.0           | 8.2  | ⏚ cl. I    | 55 | 70     |
| MPC 302 M | 42203 | 220-240            | 725-740    | 3.40-3.50              | 2     | 2800 | 3125     | 868.1  | 60.5   | 594 | 59.5           | 12.3 | ⏚ cl. I    | 55 | 70     |
| MPC 304 M | 42205 | 220-240            | 160-165    | 0.86-0.87              | 4     | 1400 | 1900     | 527.8  | 11.0   | 108 | 53.0           | 10.2 | ⏚ cl. I    | 55 | 70     |
| MPC 354 M | 42215 | 220-240            | 260-280    | 1.27-1.27              | 4     | 1400 | 3000     | 833.3  | 17.5   | 172 | 58.5           | 13.4 | ⏚ cl. I    | 55 | 70     |
| MPC 404 M | 42225 | 220-240            | 340-365    | 1.70-1.70              | 4     | 1400 | 4260     | 1183.3 | 15.0   | 147 | 60.5           | 14.0 | ⏚ cl. I    | 55 | 70     |
| MPC 254 T | 42355 | 220/380<br>240/415 | 100<br>110 | 0.58/0.33<br>0.61/0.35 | 4     | 1400 | 1100     | 305.6  | 10.0   | 98  | 48.0           | 8.2  | ⏚ cl. I    | 55 | 70     |
| MPC 302 T | 42303 | 220/380<br>240/415 | 700<br>740 | 2.68/1.53<br>3.00/1.71 | 2     | 2800 | 3300     | 916.7  | 66.0   | 647 | 59.5           | 12.3 | ⏚ cl. I    | 55 | 70     |
| MPC 304 T | 42305 | 220/380<br>240/415 | 160<br>170 | 0.66/0.38<br>0.70/0.40 | 4     | 1400 | 1950     | 541.7  | 13.5   | 132 | 47.5           | 10.2 | ⏚ cl. I    | 55 | 70     |
| MPC 354 T | 42315 | 220/380<br>240/415 | 220<br>230 | 0.84/0.49<br>0.85/0.50 | 4     | 1400 | 3050     | 847.2  | 17.5   | 172 | 54.0           | 13.4 | ⏚ cl. I    | 55 | 70     |
| MPC 404 T | 42325 | 220/380<br>240/415 | 330<br>345 | 1.00/0.64<br>1.10/0.65 | 4     | 1400 | 4300     | 1194.4 | 18.0   | 177 | 56.5           | 14.0 | ⏚ cl. I    | 55 | 70     |

## Dimensions (mm)

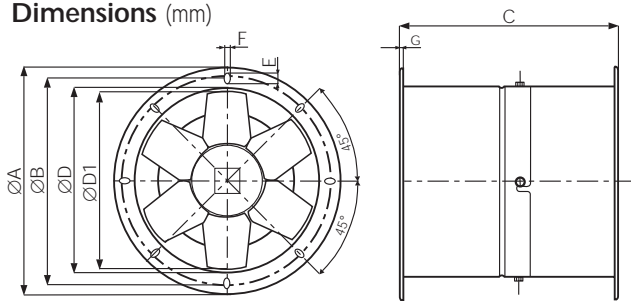

|                | Ø nom. | Ø A | Ø B | C   | Ø D | Ø D1 | E x F  | G |
|----------------|--------|-----|-----|-----|-----|------|--------|---|
| <b>MPC 252</b> | 250    | 319 | 292 | 300 | 256 | 250  | 14 x 9 | 4 |
| <b>MPC 254</b> | 250    | 319 | 292 | 300 | 256 | 250  | 14 x 9 | 4 |
| <b>MPC 302</b> | 315    | 393 | 366 | 330 | 308 | 300  | 14 x 9 | 4 |
| <b>MPC 304</b> | 315    | 393 | 366 | 330 | 308 | 300  | 14 x 9 | 4 |
| <b>MPC 354</b> | 355    | 432 | 405 | 330 | 360 | 350  | 14 x 9 | 4 |
| <b>MPC 404</b> | 400    | 475 | 448 | 330 | 410 | 400  | 14 x 9 | 4 |

## Accessories (description and data on pages 142-145).

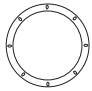
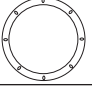
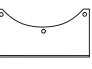
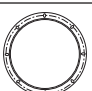
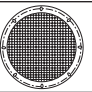
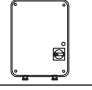
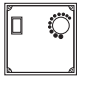
| Model   | Code  | Products                      |
|---|-------|-------------------------------|
|  MPC BO 250 (suction connector)                    | 22535 | 42253 - 42355 - 42255         |
| MPC BO 300 (suction connector)  | 22536 | 42203 - 42303 - 42305 - 42205 |
| MPC BO 350 (suction connector)  | 22537 | 42215 - 42315                 |
| MPC BO 400 (suction connector)  | 22538 | 42325 - 42225                 |
|  MPC RA 250 (flexible connector)                  | 22516 | 42253 - 42355 - 42255         |
| MPC RA 300 (flexible connector)   | 22517 | 42203 - 42303 - 42305 - 42205 |
| MPC RA 350 (flexible connector)   | 22518 | 42215 - 42315                 |
| MPC RA 400 (flexible connector)   | 22519 | 42325 - 42225                 |
|  MPC SU 250 (mounting feet)                      | 22531 | 42253 - 42355 - 42255         |
| MPC SU 300 (mounting feet)  | 22532 | 42203 - 42303 - 42305 - 42205 |
| MPC SU 350 (mounting feet)  | 22533 | 42215 - 42315                 |
| MPC SU 400 (mounting feet)  | 22534 | 42325 - 42225                 |
|  MPC FL 250 (coupling flange)                    | 22523 | 42253 - 42355 - 42255         |
| MPC FL 300 (coupling flange)  | 22524 | 42203 - 42303 - 42305 - 42205 |
| MPC FL 350 (coupling flange)  | 22525 | 42215 - 42315                 |
| MPC FL 400 (coupling flange)  | 22526 | 42325 - 42225                 |
|  MPC RP 250 (protection grille)                  | 22527 | 42253 - 42355 - 42255         |
| MPC RP 300 (protection grille)  | 22528 | 42203 - 42303 - 42305 - 42205 |
| MPC RP 350 (protection grille)  | 22529 | 42215 - 42315                 |
| MPC RP 400 (protection grille)  | 22530 | 42325 - 42225                 |
|  IRM 30 (three position single-phase controller) | 12921 | 42205 - 42255                 |
| IRM 40 (three position single-phase controller)   | 12922 | 42253 - 42215 - 42225         |
| IRT 15 (three position three-phase controller)  | 12923 | 42355 - 42305 - 42315 - 42325 |
| IRT 35 (three position three-phase controller)  | 12924 | 42303                         |
|  IREM 3 (single-phase speed controller)          | 12931 | 42253 - 42205 - 42215 - 42225 |
| IREM 5 (single-phase speed controller)*   | 12932 | 42253 - 42205 - 42215 - 42225 |
| IREM 9 (single-phase speed controller)**  | 12933 | 42253 - 42205 - 42215 - 42225 |

\* multiple regulation up to max 5 A - \*\* regulates several fans up to max 9 A