

# Xpelair DX100 & XX100

## 100mm Axial extract fans



DX100

XX100

### Key features

Application: **Domestic bathrooms, shower rooms and toilets. All models come complete with wall and window fitting kit**

Control options: **Pullcord, timer, humidistat and PIR**

Legislation: **Conforms to Building Regulations Part F1**

Hole diameter: **117mm (wall/ceiling)  
125mm (window)  
110mm (shaft/ducting)**



DX100 fan complete with Universal Mounting Kit

### Select the right product for your application

	DX100	DX100PC	DX100T	DX100H	DX100HP	DX100PIR	XX100	XX100P	XX100T
Reference number	90839AW	90840AW	90841AW	90842AW	90843AW	90844AW	90872AW	90873AW	90874AW
Remote switch (supplied separately)	■		■				■		■
Integral pullcord		■			■			■	
Integral timer (adjustable from 2-20 mins)			■	■	■	■			■
Humidity sensor (50-90% RH)				■	■				
Passive infrared sensor						■			
Maximum air flow (FID, m <sup>3</sup> /h)	76	76	76	76	76	76	76	76	76
Maximum air flow (FID, l/s)	21	21	21	21	21	21	21	21	21
Sound pressure level (dB(A)@3m)	35	35	35	35	35	35	41	41	41
Electrical power rating (W)	12	12	12	12	12	12	12	12	12
IP rating	IPX5	IPX5	IPX5	IPX5	IPX5	IPX4	IPX5	IPX5	IPX5
Universal mounting kit	■	■	■	■	■	■			
Weight (kg)	1.2	1.2	1.2	1.2	1.2	1.2	0.8	0.8	0.8
Guarantee (years, UK)	3	3	3	3	3	3	3	3	3

### The Range

A comprehensive range of stylish, compact and easy to install single speed fans. Suitable for a wide range of domestic applications including bathrooms, shower rooms and toilets, including zones 1 & 2. Also suitable for commercial applications such as hotel bathrooms, office toilets and other small rooms.

**DX100** models have a softly curved flowline grille design which will blend into wall or ceiling décor, whilst the shallow depth of the outlet spigot ensures compact window installation. All models come complete with a universal mounting kit (wall tube, gasket x2, outer grille, skirt moulding for window) suitable for wall, ceiling or window mounting (in single glazing up to 6mm) applications. The **DX** range includes an air operated backdraught shutter, outer grille and ducting. Control options include integral pullcord and timer; humidistat and PIR options offer automatic control.

**XX100** models are supplied without a kit and are ideal for replacement applications or where a suitable outlet already exists.

All models are IPX5 rated (except **DX100PIR**) and BEAB approved, demonstrating accredited levels of safety. They are all suitable for 220-240V 50Hz mains operation, have lubricated for life motors, Class B insulation for operation in ambient temperatures up to 40°C and are fitted with a thermal cut out.

## Models

### DX100

#### Ref. 90839AW

- Single speed axial unit
- Operated by a remote switch or sensor (In a bathroom normally a separate pullcord or the lighting circuit)
- Includes universal mounting kit
- Colour: White

### DX100PC

#### Ref. 90840AW

- Single speed axial unit with pullcord
- Operated by integral pullcord
- Includes universal mounting kit
- Colour: White

### DX100T

#### Ref. 90841AW

- Single speed axial unit with timer
- Timer triggered by a remote switch - usually the lighting circuit
- Adjustable timer (2-20mins)
- Includes universal mounting kit
- Colour: White

### DX100H

#### Ref. 90842AW

- Single speed axial unit with humidistat
- Automatic On/Off operation by integral humidity sensor, adjustable from 50-90% RH
- Timer function adjustable (2-20mins)
- Includes universal mounting kit
- Colour: White

### DX100HP

#### Ref. 90843AW

- Single speed axial unit with humidistat and pullcord
- Timer function adjustable (2-20mins)

- Automatic On/Off operation by integral humidity sensor, adjustable from 50-90% RH
- Pullcord On feature overrides the auto-humidity sensor function
- Includes universal mounting kit
- Colour: White

### DX100PIR

#### Ref. 90844AW

- Single speed axial unit with PIR detector
- Automatic On/Off operation
- Integral passive infrared sensor
- Includes universal mounting kit
- Colour: White

### XX100

#### Ref. 90872AW

- Single speed axial unit
- Operated by remote switch
- Colour: White

### XX100P

#### Ref. 90873AW

- Single speed axial unit with pullcord
- Operated by integral On/Off pullcord
- Colour: White

### XX100T

#### Ref. 90874AW

- Single speed axial unit with timer
- Normally triggered by a remote switch, for example the lighting circuit
- Colour: White

**Typical Specifications** on page 161.  
**Wiring Diagrams** on page 181.  
**Remote Sensors** on page 56.

## Controllers

### Remote Humidistat XRH

#### Ref. 21856AW

- Stand alone humidistat switches fan On/Off when RH reaches pre-set levels. Complete with pullcord override switch

### Time Delay Unit DT20B

#### Ref. 21850AW

- User adjustable run on timer (2-20mins)

### Passive Infrared Sensor XPIRA

#### Ref. 21871AA

- Activates fan via body movement. Ideal for infrequently used public spaces. Built in timer to prevent nuisance tripping

## Performance

### DX100 / XX100 Range Volume (C.M.F.)

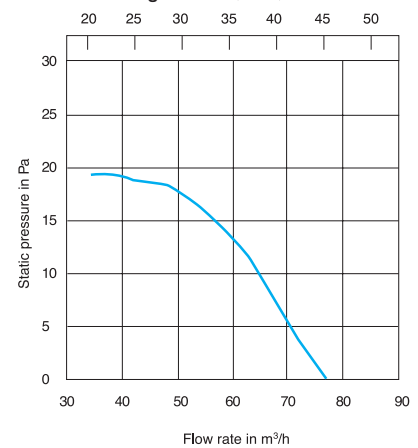

## Dimensions (mm)

### DX100 Range

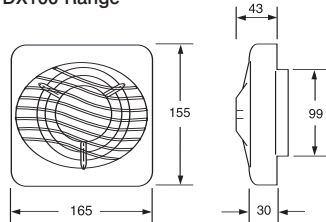

### Back draught shutter

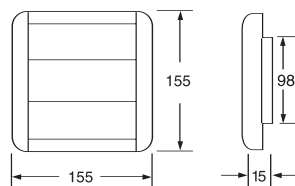

### XX100

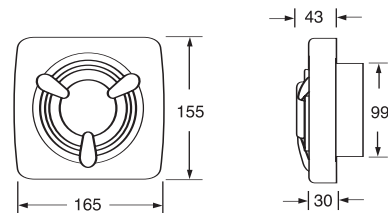

## Installation and Accessories

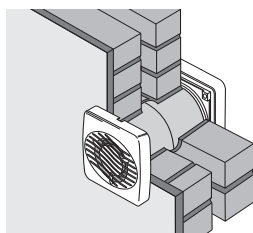

### Wall Mounting using kit provided

Hole diameter: 117mm  
 Ducting size: 100mm

### Alternative Accessories

Easy fit kit EFT  
**Ref. 90427AA**  
 Vent cowl VC10  
**Ref. 89531AA**  
 Air brick adaptor XAA  
**Ref. 89777AA**

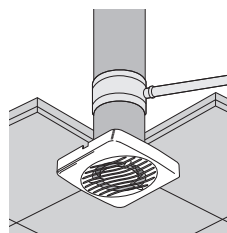

### Ceiling Mounting

Hole diameter: 117mm  
 Ducting size: 100mm

### Installation Accessories

Condensation trap XCT100  
**Ref. 89749AA**  
 Vent cowl VC10  
**Ref. 89531AA**

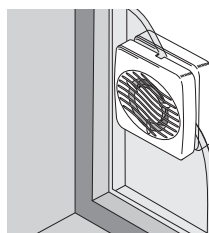

### Wall Mounting using kit provided

Hole diameter: 125mm  
 Max. glass thickness: 6mm

### Installation Accessories

Double glazing kit DXDG  
**Ref. 07439AA**

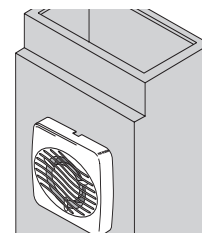

### Ventilation Shaft Mounting

Hole diameter: 110mm

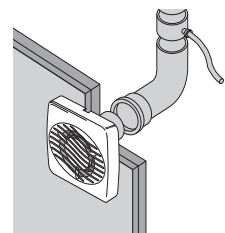

### Ducting Application

Hole diameter: 110mm  
 Ducting size: 100mm

### Installation Accessories

Condensation trap XCT100  
**Ref. 89749AA**