

Xpelair Slimline SL100, SL150 & SG150HP

Wafer thin axial fans



SL100

SL150

SG150HP

Key features

Application: **Domestic bathrooms, shower rooms, toilets, wall, ceiling and window fitting. For wall or duct mounting**

Control options: **Pullcord, timer & humidistat**

Legislation: **Conforms to Building Regulations Part F1**

Spigot diameter: **100mm (SL100)
150mm (SL150)**



Excludes the SG150HP



Wafer thin grille

The Range

Meet the new generation of Xpelair **Slimline SL100** and **SL150** fans, with wall hugging wafer-thin grilles designed for modern living. They are white in colour and are ideal for domestic bathrooms, shower rooms, toilets and other small rooms. With an internal projection of only 10mm, the 100mm Xpelair **Slimline** unit is one of the lowest profile bathroom fans available. For bigger bathrooms **Slimline** is also available in a 150mm size offering performance and style (SG150HP internal projection of 58mm).

For rooms with no opening windows **Slimline SL100** is available with a built-in overrun timer. Humidistat models are available for shower rooms and heavily used bathroom applications. Ordering is straightforward: simply select the size and control option required, then add the appropriate window or wall kit (SG150HP comes with a window kit).

But the **Slimline** range doesn't just have a pretty face, installation is simple too. All **Slimline** models have two adjustable QuickClamp fixings which make traditional wall plug and screw fixings a thing of the past (excluding the SG150HP).

The IPX4 rated units fully meet the requirements of the Building Regulations for bathrooms, toilets and kitchens and the IP requirements for zone 1 and zone 2 as defined by the IEE Wiring Regulations (16th Edition) BS7671:2001. All models are suitable for a supply voltage of 220-230V 50Hz and ambient temperatures up to 40°C.

Select the right product for your application

	SL100	SL100P	SL100T	SL100HT	SL150	SL150P	SL150T	SL150HT	SL150HP	SG150HP
Reference number	91225AW	91226AW	91227AW	91228AW	91229AW	91230AW	92361AW	91231AW	91496AW	92349AW
Remote switch (supplied separately)	■		■	■	■		■	■		■
Integral pullcord		■				■			■	■
Integral timer (adjustable up to 15 mins)			■	■			■	■	■*	■*
Integral humidity sensor (45-99% RH)				■				■	■**	■**
Extract performance (FID, m³/h)	67	67	67	67	218	218	218	218	218	218
Extract performance (FID, l/s)	18.5	18.5	18.5	18.5	60	60	60	60	60	60
Sound pressure level (dB(A)@3m)	39	39	39	39	43	43	43	43	43	43
Electrical power rating (W)	15	15	15	15	35	35	35	35	35	38
IP rating	IPX4	IPX4	IPX4	IPX4	IPX4	IPX4	IPX4	IPX4	IPX4	IPX2
Weight (kg)	0.6	0.6	0.6	0.6	0.9	0.9	0.9	0.9	0.9	1.5
Guarantee (years, UK)	2	2	2	2	2	2	2	2	2	2

* Adjustable upto 0-35 mins ** 50-80% RH

Models

SL100

Ref. 91225AW

- Single speed axial fan
- Operated by remote switch or sensor (in a bathroom normally a separate pullcord or lighting circuit)
- Colour: White

SL100P

Ref. 91226AW

- Single speed axial fan with pullcord
- Operated by integral On/Off pullcord switch
- Colour: White

SL100T

Ref. 91227AW

- Single speed axial fan with timer
- Timer triggered by remote switch-usually the lighting circuit
- Timer variable from 3-15mins
- Colour: White

SL100HT

Ref. 91228AW

- Single speed axial fan with humidistat and overrun timer
- Built in adjustable humidistat

- Integrated overrun timer eliminates nuisance tripping
- Timer variable from 45s-15mins
- Colour: White

SL150

Ref. 91229AW

- Single speed axial fan
- Operated by a remote switch or sensor, usually a lighting circuit
- Built in backdraught shutter
- Colour: White

SL150P

Ref. 91230AW

- Single speed axial fan with pullcord
- Operated by integral On/Off pullcord switch
- Built in backdraught shutter
- Colour: White

SL150HT (SL150T see page 39)

Ref. 91231AW

- Single speed axial fan with humidistat and overrun timer
- Built in adjustable humidistat
- Integrated overrun timer eliminates nuisance tripping
- Timer variable from 45s-15mins

- Built in backdraught shutter
- Colour: White

SL150HP

Ref. 91496AW

- Speed increases automatically as humidity increases
- Integral On/Off pullcord gives full speed manual override
- Built in backdraught shutter
- Colour: White

SG150HP

Ref. 92349AW

- Speed increases automatically as humidity increases
- Integral On/Off pullcord gives full speed manual override
- Built in backdraught shutter
- Colour: White
- Can be window mounted, and has a built in silent action electro-thermo shutter cassette, and an external grille

Typical Specifications on page 162.
Wiring Diagrams on page 181.
Domestic Accessories on page 59.

Performance

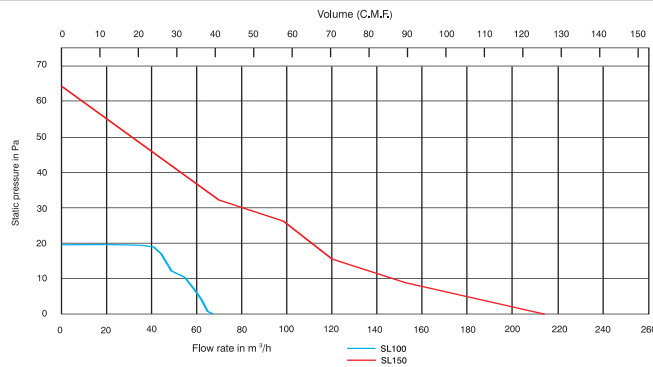

Controllers

Passive Infrared Sensor XPIRA

Ref. 21871AA

- Activates fan via body movement
- Ideal for infrequently used public spaces
- Built in timer to prevent nuisance tripping



Remote Time Controller DT20B

Ref. 21850AW

- User adjustable run-on timer (2-20mins)

Dimensions (mm)

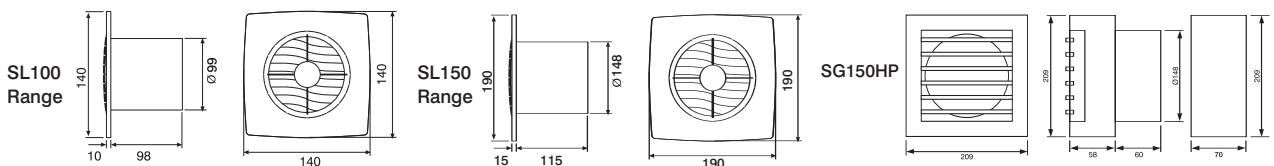

Installation and Accessories

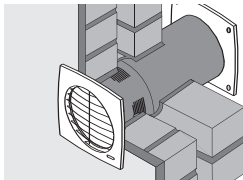

Wall Mounting

Hole diameter: 117mm (SL100)
157mm (SL150)

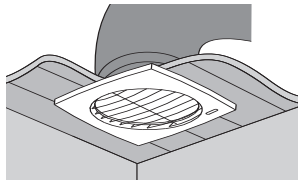

Ceiling Mounting

Hole diameter: 100mm (SL100)
157mm (SL150)

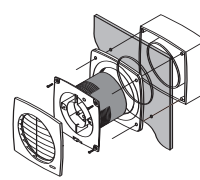

Window Mounting

Hole diameter: 100mm (SL100)
150mm (SL150)

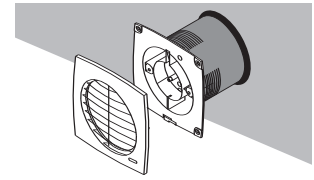

Ducted Applications

Hole diameter: 117mm (SL100)
157mm (SL150)
Duct diameter: 100mm (SL100)
150mm (SL150)

Installation Accessories

SL100 wall kit SLWK
Ref. 91232AW
SL150 wall kit SLWK
Ref. 91233AW

Installation Accessories

Flexible ducting FD100
Ref. 89910AA
Flexible ducting FD150
Ref. 89671AA
Condensation trap XCT100
Ref. 89749AA

Installation Accessories

SL100 window kit
Ref. 91234AW
SL150 window kit*
Ref. 91235AW

* Backdraught shutter must be removed

Installation Accessories

Flexible ducting FD100
Ref. 89910AA
Flexible ducting FD150
Ref. 89671AA