

# Xpelair WH30, WH60 & WHP30

## Commercial wall heaters



### Key features

Type: **Wall Mounted Heaters**

Application: **Commercial and Industrial**

Control options: **Integral/remote**



### The Range

The Xpelair **WH** range of wall heaters have stood the test of time to remain market leaders.

The **WH** range is perfect for use in factories, warehouses, workshops, canteens, and is also ideal for public areas of shops, waiting rooms, office, garages, hospitals, large stores and even agricultural applications.

Whatever the size, shape and application of a project, the **WH** range has a unit that will suit its heating requirements. Efficient, stylish, discreet and energy efficient, the **WH** range offers choice, flexibility and outstanding heating performance.

This has resulted in a range of tough, compact space heaters for the most demanding environments.

The **WH30** and **WH60** models provide robust and rugged heating units, while the **WHP30** provides comfortable, reliable heating solutions for shops, offices, domestic workshops and conservatories.

The **WH** range has gained a worldwide reputation for excellence and the range continues to be built to the high standard that has won it this acclaim.

### Select the right product for your application

	WH30	WH60	WHP30
Reference number	98392AC	00147AC	89999AW
Remote switch (not supplied)	■	■	
Electrical power (kW)	3	6	3
Phase	1	1 or 3	1
Air delivery (m <sup>3</sup> /h)	274	311	300
Air delivery (l/s)	76	86	83
Temperature increase (°C)	26	45	30
Weight (kg)	5	6.5	2.9
Guarantee (years, UK)	1	1	1

## Models

### Xpelair WH30 Ref. 98392AC

- 3kW industrial fan heater
- Compact wall hung design
- Heavy duty steel casing with die cast aluminium guards
- Spiral wound Nichrome wire element
- Metal wall bracket
- Multi directional positioning -180° horizontal swivel and 45° vertical tilt then locked in position
- Wall bracket cover
- Double safety feature of thermal cut out with auto reset and one shot fusible link
- Single phase product
- For cool air circulation facility and thermostatic heating control use HC301 Controller (not supplied)

### Xpelair WH60 features over the WH30 Ref. 00147AC

- 6kW industrial fan heater
- Wall or ceiling mounting with multi directional positioning - 180° horizontal swivel and 45° vertical tilt then locked in position
- Suitable for Single and Three phase supplies
- Operated by remote switch (not supplied)

### Xpelair WHP30 Ref. 89999AW

- 3kW commercial fan heater
- Fan heater complete with HC301 thermostatic controller
- Compact wall hung design
- Flame retardant polycarbonate / glass filled nylon casing
- Spiral wound Nichrome wire element
- Grey wall bracket
- Multi directional positioning - 180° horizontal swivel and 45° vertical tilt then locked in position
- Double insulated with two thermal cut outs
- Finished in a white and grey casing
- Single phase product
- For cool air circulation facility and thermostatic heating control use HC301 Controller (included)

**Typical Specifications** on page 172.  
**Wiring Diagrams** on page 187.  
**Remote Sensors** on page 102.

## Controllers

### HC301 Controller for WH30 and WHP30 Ref. 21877AW

- Controller provides On/Off switching combined with fan only or fan and heater operation. Variable thermostatic control. Not suitable for WH60.



## Dimensions (mm)

### WH30

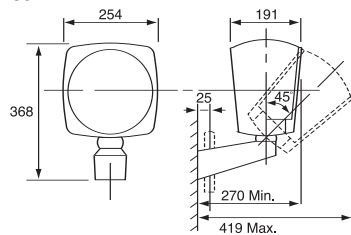

### WH60

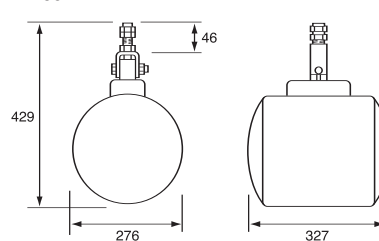

### WHP30

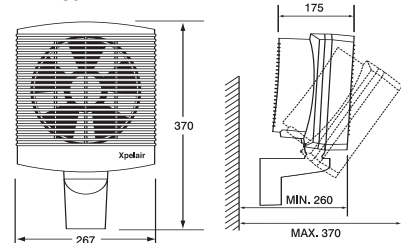

## Installation and Accessories

### WH30

Should be sited between 2m and 2.5m from the floor level to the centre of the unit, a minimum of 200mm from the ceiling and 100mm from adjacent walls and other objects. Not recommend for rooms with a ceiling height greater than 5m.

### WHP30

Should be sited at least 1.8m from the floor level to the centre of the unit, a minimum of 150mm from the ceiling and 300mm from adjacent walls and other objects. Not recommend for rooms with a ceiling height greater than 5m.

### WH60

Recommended height 2.3m – 2.6m floor to centre of heater