

Xpelair Xpress XPRS

High pressure mixed flow inline duct fans



XPRS200

XPRS250

XPRS355

Key features

Type:	Mixed flow inline
Application:	Commercial/Industrial
Control options:	Speed control and humidity/PIR sensing

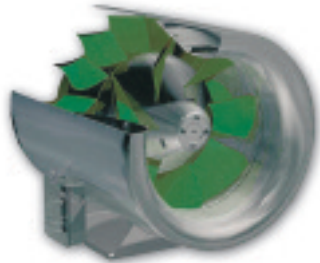

Cutaway of Xpress showing design of impellor and down stream guidevanes

The Range

The New Xpelair **Xpress** range redefines inline fan performance to provide ultra high pressure development, volume and efficiency allowing smaller ductwork to be used than conventional inline fans.

At the heart of the design is a dynamically balanced mixed flow impeller and bellmouth entry with minimised clearances to ensure optimum pressure development. Transferred through a meridian channel, the air then enters a static three dimensional guide vane. This dihedral twist retains a third of the pressure build up which would otherwise be lost. The air management is so efficient that air turbulence noise and vibration associated with centrifugal inline fans is virtually eliminated. For example

an **Xpress** 250mm at 200Pa has a volume output double that of an equivalent size centrifugal inline fan and 50% higher than 315mm. This impressive performance means that smaller ducts can be chosen with an energy use lower than most DC fans of the same performance. **Xpress** is no bigger in diameter than the ductwork in which it is mounted. No flanges are required; simply flexible connections. It comes with its own mounting foot which is factory fitted to eliminate on site assembly. And the new Xpelair **Xpress** can be run at any angle.

Space saving, smaller ductwork, quieter and costing less to run, the technically advanced Xpelair **Xpress** redefines inline performance.

Models

- High pressure inline mixed flow fans
- Steel housing with bell mouth entry (XPRS200 is plastic)
- Mixed flow fabricated blade and hub assembly balanced to G2.5 ISO 1940
- Continuously rated capacitor start and run motor with integrated thermal overload protection
- Matching aerofoil section guidevanes
- Integral mounting foot
- Terminal box to IP44
- Voltage speed controllable

Select the right product for your application

	XPRS200	XPRS250	XPRS315	XPRS355/1	XPRS355/2
Reference number	92358AA	91498AA	91499AA	91500AA	91501AA
Extract performance (m ³ /s)	0.42	0.47	0.96	0.71	1.38
Casing break out (dB(A)@3m)	47	35	43	32	50
Motor electrical power (W)	110	190	520	145	990
Electrical current FLC (A)	0.5	0.9	2.5	0.7	4.6
5 step transformer speed controller	n/a	91367AA	31968AA	91367AA	91369AA
Guarantee (years)	2	2	2	2	2
Fan rpm	2800	2890	2860	1460	2840
Weight (kg)	3.6	6.7	14.3	17.1	13.5

Controllers

5 Step Transformer Speed Controller

- Multi-tapped auto transformer giving 5 speeds allowing accurate adjustment to suit site conditions
- Provides five speed and On/Off function
- Robust ISO casing
- IPX4 protected



Typical Specifications on page 177.
Control Details on pages 154.
Domestic Accessories on page 158-159.

Installation and Accessories

Solid duct fasteners XMK

200	Ref. 89621AA
250	Ref. 89622AA
315	Ref. 89623AA



Backdraft shutter XBD

200	Ref. 89639AA
250	Ref. 89640AA
315	Ref. 89641AA



Filter box CFC

200	Ref. 90287AA
250	Ref. 90288AA
315	Ref. 90289AA

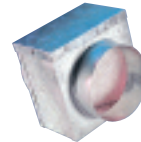

Inline Duct Heater IDH

200	Ref. 90273AA
250	Ref. 90274AA
315	Ref. 90275AA

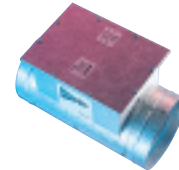

Performance

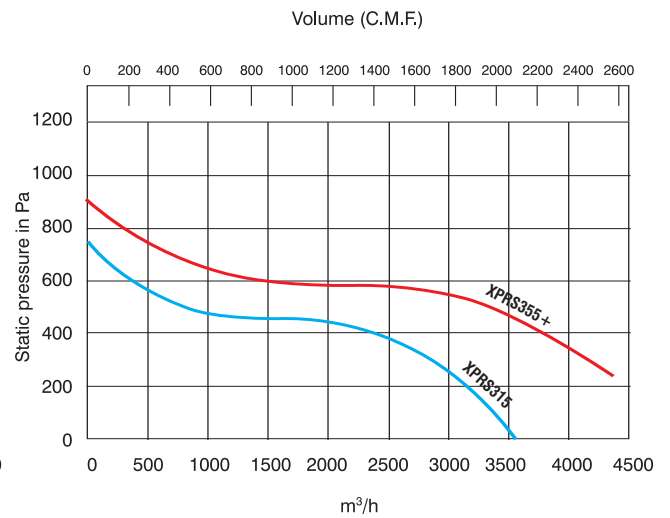
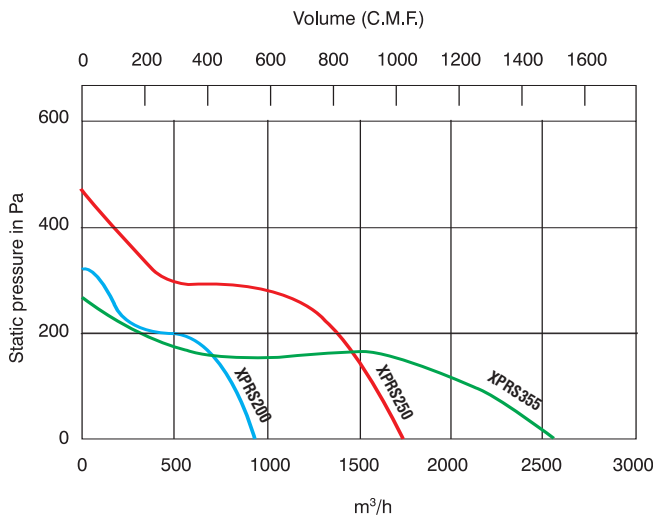

Dimensions (mm)

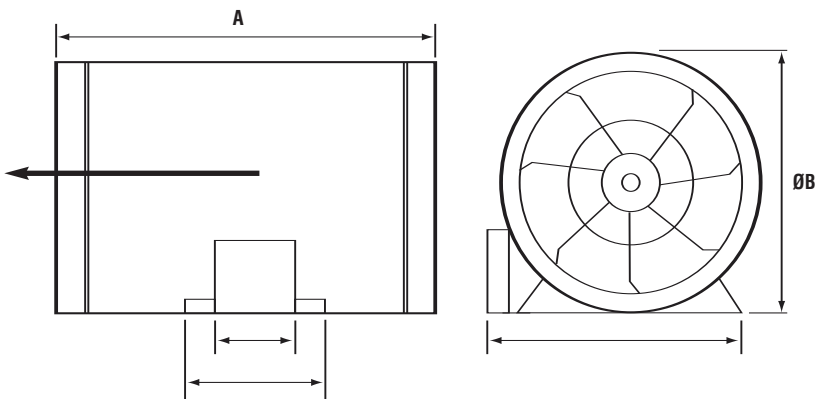

Model	Dimensions (mm)	
	A	ØB
XPRS200	225	200
XPRS250	280	250
XPRS315	355	315
XPRS355/1	400	355
XPRS355/2	400	355