

# O nice

1000 | 1600 | 2000



graphic www.calefidosvs  
**E**lectron



[www.siragroup-onice.it](http://www.siragroup-onice.it)

Italiano

English

Français

Deutsch

Español

Português

中文

Русский

INDEX

WARNINGS AND RECOMMENDATIONS	Pag. 01
COMPLIANCE DECLARATIONS	Pag. 02
RANGE AND SIZES	Pag. 02
ELECTRICITY SUPPLY	Pag. 02
INSTALLATION	Pag. 03
INSTRUCTIONS FOR UNINSTALLING THE RADIATOR	Pag. 06
INSTRUCTIONS FOR USE	Pag. 06
MAINTENANCE	Pag. 17
GUARANTEE	Pag. 17
DISPOSAL	Pag. 18
TECHNICAL CHARACTERISTICS	Pag. 18

WARNINGS AND RECOMMENDATIONS



**Never cover a functioning radiator with clothing and/or objects as this may cause dangerous overheating.**

When using the radiator, follow only the instructions found in this manual. Conserve this instruction manual for the entire life of the product.

The Onice radiator has been conceived to heat a room. It must not be adopted for other uses.

It is dangerous to modify or alter in any way the characteristics of this radiator.

The radiator must be installed according to lawful standards which regulate electrical installations.

It is recommended to consult a qualified professional for installation of electrical connections.

This radiator is to be used exclusively by adults. Children or others using the radiator must be supervised.

Leave at least 50 cm of space between the radiator and any inflammable objects.

For any cleaning or maintenance operations, the radiator must be turned off and unplugged.

The materials used in packing this radiator are recyclable. It is recommended to dispose of this material in an appropriate manner.

If the electrical cord is damaged, it must be replaced by the manufacturer or an authorized Service Assistant.

Do not utilize this radiator if the control panel (display) is damaged. In case of technical problems, contact your retailer, distributor or installer.

Do not lean against or climb on the radiator. Do not touch the radiator with wet or damp hands or feet.

Do not insert or place any items inside the radiator.

## COMPLIANCE DECLARATIONS

The manufacturer accepts responsibility that the radiator has been designed and constructed in compliance with the following guidelines:



English

## PRODUCT RANGE AND SIZES

Power (Watt)	Width (mm)	Height (mm)	Depth (mm)	Weight (Kg)
1000	535	575	95	12
1600	775	575	95	17
2000	935	575	95	21

## ELECTRICITY SUPPLY

Installation must be carried out in accordance with national standards in force.  
Before using the first time, verify that the supply of current corresponds to that indicated on the radiator.

This radiator is in Insulation Class II and therefore no ground connection is necessary.

Single-phase supply 230 V +10% - 10% 50Hz

Protection grade: IP24

Respect the color of the wires for the connections.

Brown = phase

Blue = neutral

Nero = pilot wire - **Isolate the pilot wire if it is not in use.**

## INSTALLATION

**Safety precaution: before and during installation, make sure that the radiator is not connected to the electricity supply.**

This radiator is in Insulation Class II and can therefore be installed in all rooms of homes including zones 2 and 3 (see figure below) of a bathroom, sheltered from any contact with water (see fig.1). In full compliance with existing regulations in France (NF C15-100), the radiator must be positioned in such a way so as the control panel is out of reach of anyone in the shower or bath.

The radiator cannot be installed above an electrical outlet.

The radiator must be positioned at least 15 cm from any obstacle (walls, furniture, shelves etc.)

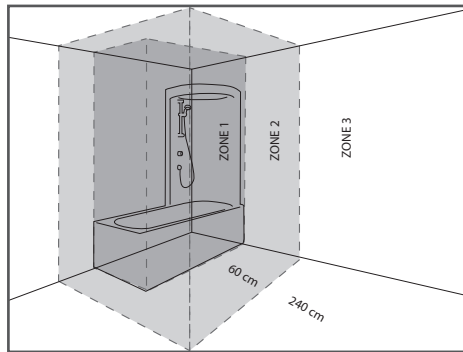
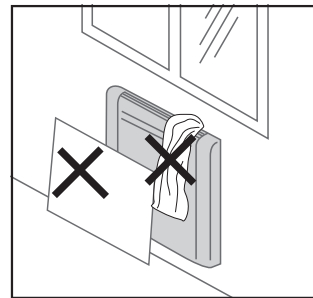
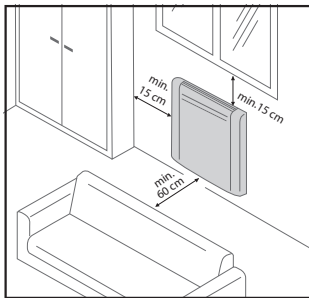

fig. 1

## CORRECT POSITIONING OF RADIATOR



Unpack the radiator and place it carefully on the ground, using the polystyrene as protection. Make sure that the radiator and cords have not been damaged during transport.

If damaged, do not use the radiator.

During installation, verify that the radiator is not plugged in.

Verify that the home voltage corresponds to that indicated on the radiator (220V – 230V).

For easy installation, your radiator is equipped with an installation kit containing 2 brackets, 4 screws, 4 screw anchors and a paper template (diagram indicating the position of holes to be drilled) in function of the type and size of the radiator.

Follow the instructions below:

**1.** Position the paper template against the wall holding it perfectly parallel to the floor. The lower end of the paper should just touch the floor. In this way the radiator will be positioned at the correct height.

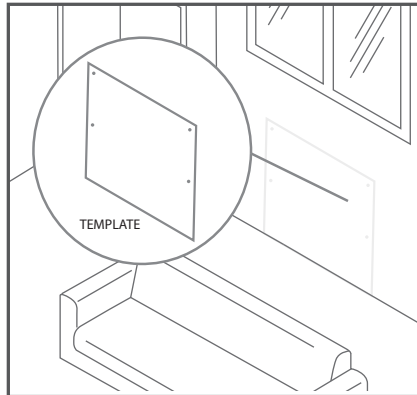

fig. 2

**2.** Using the template, use a pencil to mark the position of the 4 holes indicated for your model of radiator. Drill 4 holes in the wall with a diameter of 10mm and a depth of 50-55mm (fig. 2)

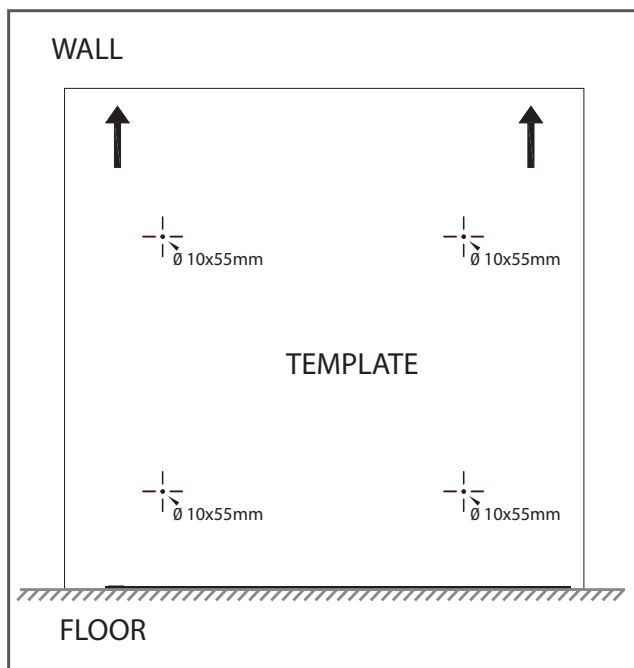
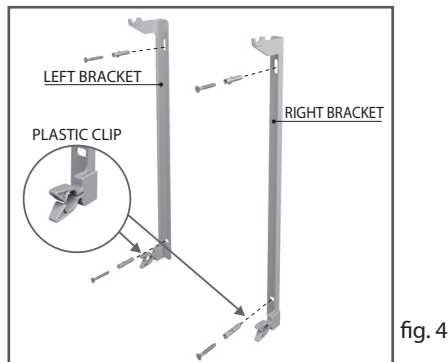
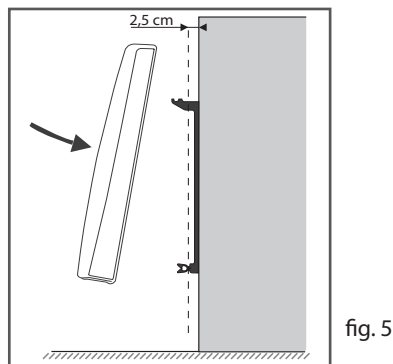

fig. 3

**3.** Insert the plastic screw anchors into the four holes, using a hammer if necessary. Position the two brackets in correspondence of the holes and fix them to the walls with the screws. (fig. 4).



**4.** Take the radiator and rest it on the brackets (fig. 5). To verify the correct position, measure the space between the radiator and the wall: it should be 2.5 mm.



**5.** Observing from above the space between the radiator and the wall (fig.6), verify that the radiator is in the correct position to be inserted into the two plastic clips of the brackets.

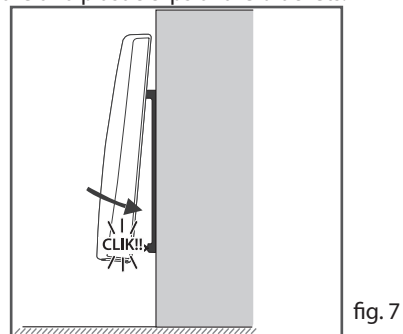
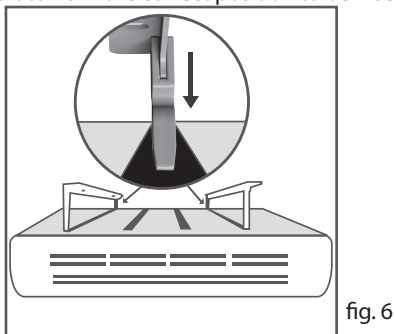

**6.** Exert pressure on the bottom part of the radiator until you hear a click (fig. 7). At this point, installation is terminated.

INSTRUCTIONS FOR UNINSTALLING THE RADIATOR

**Safety precaution: before uninstalling the radiator, make sure that the radiator is not connected to the electricity supply.**

To uninstall the radiator, press in at the top while simultaneously pulling out at the bottom until radiator is released (fig.8).

English

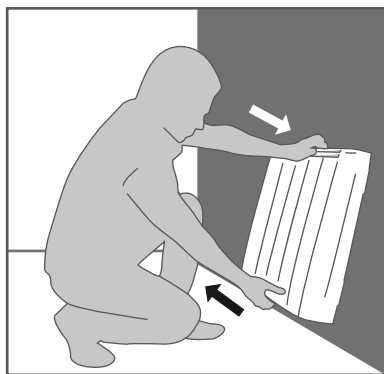
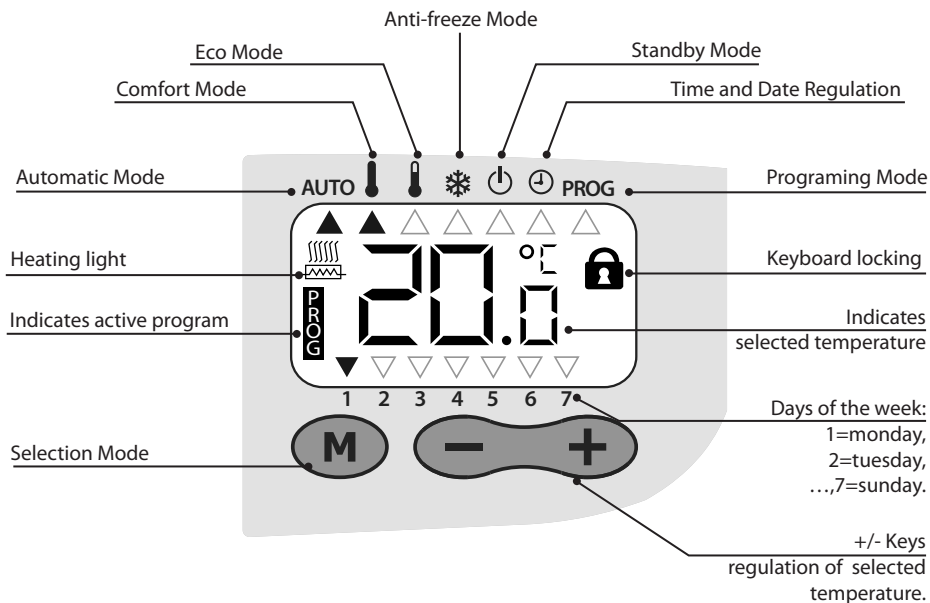

fig. 8

INSTRUCTIONS FOR USE



### STARTING THE RADIATOR

Plug in the radiator and press the **Mode button** to start the radiator functioning.

The **Mode button** permits you to select the settings and function of the radiator according to your needs. The various settings in order are: **Time and date regulation > Programming > Auto > Comfort > Economy > Antifreeze > Standby**. The first function that is visualized on the display is regulation of time and date mode.

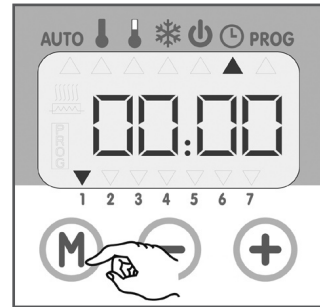

### TIME AND DATE REGULATION MODE

In this mode it is possible to regulate the time and date in order to program the functioning cycle of the radiator.



**1. Setting the time:** Press the + or - buttons to set the hours (hours will flash).  
Select by pressing **M** (Hours stop flashing).  
To rapidly scroll the hours, hold down + or -.

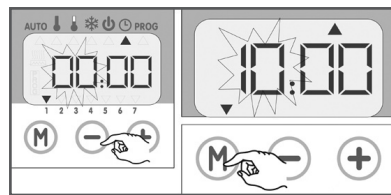

**2. Setting the minutes:** Press the + or - buttons to set the minutes (minutes will flash).  
Select by pressing **M** (minutes stop flashing).  
To rapidly scroll the hours, hold down + or -.

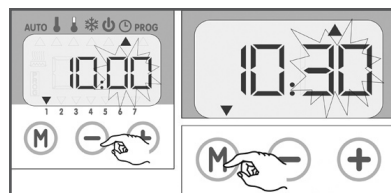

**3.** Setting the day: after having set the minutes, the cursor is situated above no. 1 (Monday) and begins to flash.

Select the day by pressing + or – and set by pressing **M**. (cursor stops flashing).

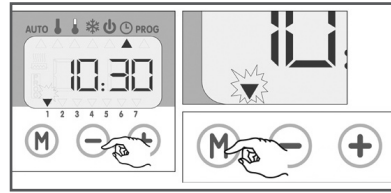

**4.** To exit the time and date regulation mode, press **M**.

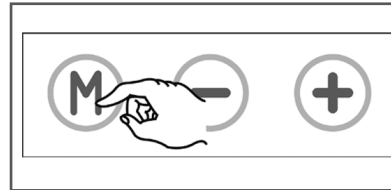

## PROGRAM MENU

This set up allows you to choose between 4 different programs. (**P1**, **P2**, **Comfort (P3)**, **Economy (P4)**), to choose as you wish according to the days and hours that you have selected.

The factory default setting is Comfort.



**P1:** the radiator functions in **Comfort Mode** from 6.00 to 22.00 and in Economy mode from 22.00 to 6.00.

**P2:** the radiator functions in **Comfort Mode** from 6.00 to e 9:00 and from 16:00 to 22:00; it is in economy mode from 9.00 to 16.00 and from 22.00 to 6.00.

**Comfort (P3):** the radiator functions in **Comfort mode** 24h/24h for the day of the week selected. Initially, the temperature in Comfort mode is set at 20° C for everyday of the week. You can vary the temperature level in the Comfort mode to your pleasure. (see temperature regulation in **Comfort mode**).

**Economy (P4):** the radiator functions in **Economy mode** 24h/24h for the day of the week selected. Initially, the temperature in Economy mode is set at 16.5° C , 3.5°C less than the temperature in the **Comfort mode**. You can vary the temperature level in the **Economy mode** to your pleasure. (see temperature regulation in **Economy mode**).

## PROGRAM SELECTION

1. Pressing button **M**, position the cursor on **PROG** ; at this point, the cursor above the day of the week will begin to scroll from 1-7, displaying the program set up for everyday of the week.



2. Pressing **+ o -** buttons positions the cursor on the day (1= Monday ... 7= Sunday) and the program selected for that specific day will flash.

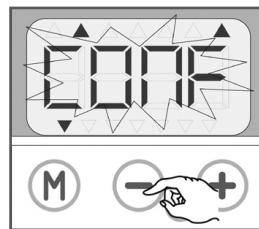

3. Pressing **+ o -** buttons select the program that you wish for that day and set by pressing **M**.

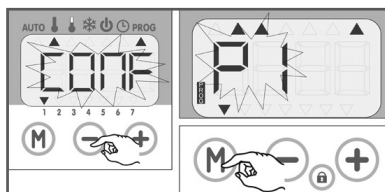

4. Once the previous operation is terminated, the program set for the following day (2=Tuesday) will begin to flash.

To modify the program set for day 2, repeat the operation described in point 3 above.

Repeat the operation for each day of the week until day 7 (Sunday).

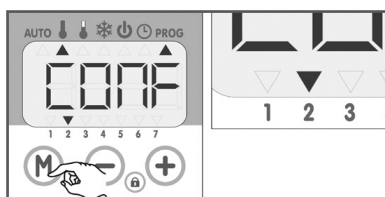

5. Once you have selected the program until the last day of the week (Sunday) and pressed **M**, the cursor above the days of the week will begin to scroll from 1-7, displaying the set programs.

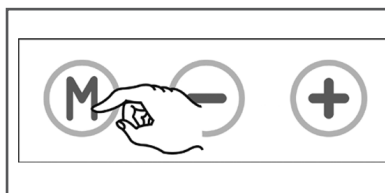

### VERIFICATION OF SELECTED PROGRAMS

To visualize or modify selected programs press **M** to position the cursor **PROG**. The cursor above the day of the week will begin to scroll from 1-7, displaying the program set up for each day of the week. In this condition you can modify the set program by pressing the + or - buttons and repeating the operations described above (points 2 – 5).

To exit the visualization of programs, press **M**.

### MODIFYING HOURS OF PROGRAMS P1 E P2

If the factory set hours of the programs **P1** e **P2** are not satisfactory, you can modify them.  
e.g. modifying **P1** hours:

1. Pressing the **M** button, position the cursor on **PROG**. The cursor above the day of the week will begin to scroll from 1-7, displaying the program set up for each day of the week.



2. Press + or - and select **P1**. **P1** begins to flash.

Hold down **M** for 6 seconds.

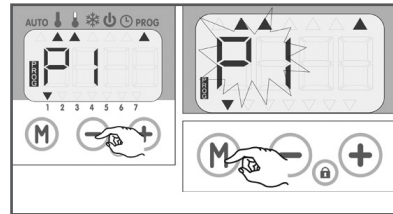

3. the starting hour of **P1** ( 6:00) begins to flash. Press + or - to modify the starting hour. Each press of + or - will vary the hour by 30 minutes.

Press **M** to set the hour.

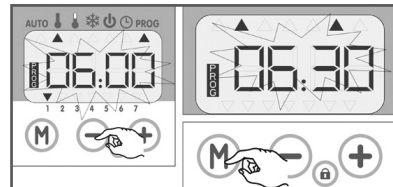

4. The final hour of P1 ( 22:00) begins to flash. Press + or – to modify this hour. Each press of + or – will vary the hour by 30 minutes. Press **M** to set the hour. **P1** is now modified automatically with the new hours set for each day of the week.

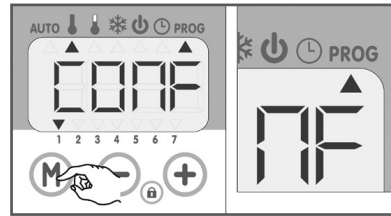

5. Press **M** to exit from the program.



To modify **P2**, proceed in the same manner as for **P1** described above.

**AUTOMATIC (AUTO MODE)**

In this mode, the radiator will function according to the personalized program that you have chosen or according to a centralized programmer with an active pilot wire (where present).

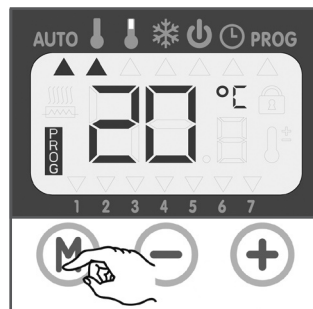

English

**COMFORT MODE**

The Comfort mode allows you to regulate the temperature in a constant and fixed manner (24h/24h), for example 20° C.

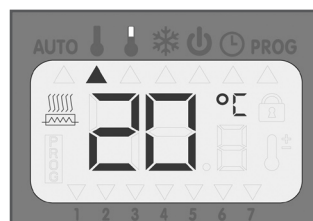
**Temperature regulation in comfort mode**

Pressing **M**, position the cursor on Comfort mode and select the desired temperature by pressing **+** or **-**. The temperature can be set from 10 – 30°C with 0,5°C intervals.

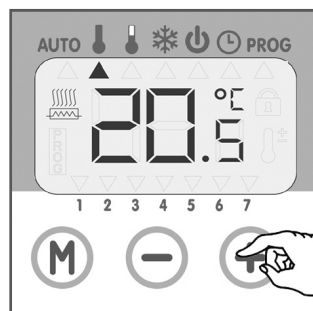
**ECONOMY MODE**

The **Economy mode** permits the radiator to function economically and corresponds to the Comfort temperature, less 3.5° C (16.5° ). To change the default difference between the Comfort temperature and the Economy temperature, please consult the section on "Advanced Regulation."



### ANTIFREEZE MODE

The **Antifreeze mode** protects your home, prohibiting the ambient temperature from going below 7°C. To change the default Antifreeze temperature please consult the section on "Advanced Regulation".

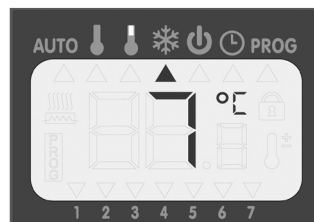

### STAND BY MODE

This mode permits you to temporarily turn off the heating while maintaining the radiator plugged in (indicated on display).

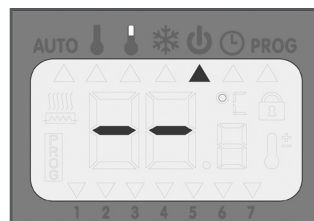

## ADVANCED REGULATION

### Regulation of temperature difference between Comfort and Economy Modes

It is possible to change the temperature difference between the **Comfort mode** and the **Economy mode** (-3.5°C default) from -1 to -8°C.

1. In **Economy mode**, simultaneously press **M** and **+** for approximately 8 seconds until the factory default temperature appears on the display (-3.5°C), with **PROG** written next to it.
2. Press **+ o -** to select the new temperature difference that you desire (e.g. -5°C)
3. Press **M** to set the temperature difference.

### Regulation of temperature in Antifreeze mode

The default Antifreeze temperature is 7°C. It is possible to set this temperature from 5-15°C.

1. In the antifreeze mode, simultaneously press **M** and **+** for approximately 8 seconds until the factory default temperature appears on the display (7°C), with **PROG** written next to it.
2. Press **+ o -** to select the new temperature desired.
3. Press **M** to set the temperature

### Managing radiator by means of remote control

The radiator can be connected to a climate control unit by means of a remote control device. In this way, the different modes of radiator functioning can be activated at a distance. Radiator functioning by means of remote control is possible only in the Auto mode. In other modes (Comfort, Economy etc.) signals from the remote are not received. Commands by remote control always has priority over the manual setting of individual radiators.

### Temporary cancellation of a command received from a remote control device

When necessary, it is possible to cancel a command coming from a remote control device e.g.

1. the climate control unit send an Eco command (e.g. 16.5°C)
2. Pressing **+ o -** on the radiation allows you to regulate the temperature (e.g.. 20.5°C)

This modification will automatically be cancelled when the next signal from the remote is received.

### Resetting original settings (reset)

0 return to factory default settings, press **M**, **+** and **-** simultaneously for approximately 8 seconds. Factory default settings: Comfort = 20°C, Eco = Comfort -3.5°C, Antifreeze = 7°C

### Child Safety Keyboard Lock

To block the keyboard display, press and hold down the **+** and **-** buttons simultaneously for approximately 6 seconds. A symbol of a lock will appear on the display. To deactivate the keyboard block, press and hold down the **+** and **-** buttons for 3 seconds. The symbol of the lock will disappear.

### Regulation of Display Illumination

Pressing **M**, position the cursor in Stand By mode Simultaneously **M** and **+**.

Two modes of regulation will appear on the screen:

**L1** = timed backlighting (The **L1** mode is set in the factory)

**L2** = permanent backlighting.

Press **+** to go from **L1** to **L2** and vice versa

Press **M** to set your selection

### Temporary Interruption of Power Supply

In cases of temporary interruption of the power supply, the radiator will automatically reset its preexisting values. The array of regulation parameters, such as the clock, are saved. When power returns, all preceding values will be reestablished.

## MAINTENANCE

In order to maintain correct radiator functioning and performance as guaranteed by the manufacturer, it is advised to regularly check that the superior and inferior grids are not blocked. The grids can be cleaned by using a normal vacuum cleaner. This will assure a better quality of air in the environment. If the grids are blocked by dirt or any type of object which cause a malfunctioning of the radiator, the radiator will not be replaced under the guarantee. Clean the surface of the radiator with a damp cloth and a ph neutral soap. Do not use alcohol, solvents or any abrasive materials.

## GUARANTEE

The manufacturer guarantees that the radiator conforms to European Directive 1999/44/CE. The body of the radiator is guaranteed for 15 years. Electrical and electronic parts (including accessories connected to these) are guaranteed for 2 years.

This guarantees the repair or replacement of defective products depending on the discretion of the manufacturer.

The guarantee is valid only if:

- Installation standards as well as warnings and recommendations found in this manual are respected.
- There are manufacturing defects present when the product is sold, noted within two years of the sales date.

The guarantee is not valid if:

- There are defects present caused by uses of the product other than those specified in Warnings and Recommendations contained in this Instruction manual.
- There are evident defects caused by accidental breakage or negligence.
- The radiator has been repaired or tampered with by non-authorized personnel.
- The radiator has been damaged during transport.
- The radiator has not been correctly connected to the power supply.

The manufacturer declines all responsibility for any damage to persons, animals or objects, caused directly or indirectly as a consequence of not following instructions in this manual in regard to Warnings, Recommendations and Installation.

To request the guarantee, the Client must contact the distributor or installer with a sales receipt from the retailer showing the purchase date of the product

## DISPOSAL

### Instructions for proper disposal of the product in compliance with European Directive 2002/96/EC.

A radiator no longer in use is not to be disposed of with domestic refuse. It must be brought to a specific recycling center for the disposal of electric and electronic apparatuses (RAEE) or returned to the retailer to be replaced with a new radiator.

For information regarding such recycling centers, please contact your local administration. Using recycling centers for the disposal of electronic helps to protect health and the environment and permits salvaging its components, with a consequent savings of energy and natural resources.

The symbol below represents a trash container not to be used for such disposal.



## TECHNICAL CHARACTERISTICS

- Voltage: 230VAC +10%-20% 50 hz
- Safety: compatible with Class II in compliance with EN60335-1, EN60335-2-30
- Environment: IP 24
- Storage temperature: -20 ° to + 50°C
- Electronic regulation proportionally integral
- Safeguarding regulations in case of sector breakage.
- Power outlet: Semiconductor ordered at 0 of current, commutable power.

Sira Group  
Headquarters

Via Bellini, 11 - 40067 Rastignano (BO) - Italy  
Tel. +39 051 626 8411 Fax +39 051 743 866  
[www.siragroup.it](http://www.siragroup.it)  
[sira@siragroup.it](mailto:sira@siragroup.it)